

Studio Flat for sale
Tudor Close, London,
SW2 2AA Offers Over:
£220,000 Leasehold

haart
BRIXTON

02045 128359

Available 8am - 10pm every day

haart.co.uk



Ref: HRT01112743

Tudor Close SW2
 Approximate Gross Internal Area
 26.9 sq m / 290 sq ft

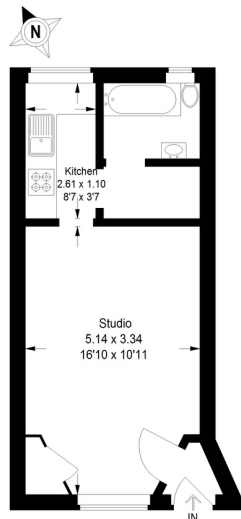

Ground Floor

This plan is for layout guidance only. Not drawn to scale unless stated. Windows and door openings are approximate. Whilst every care is taken in the preparation of this plan, please check all dimensions, shapes and compass bearings before making any decisions reliant upon them. (ID900038)

A large studio apartment located within the popular Tudor Close private development benefitting from a shared residents swimming pool and well maintained communal grounds.

- Chain Free
- Excellent Transport Links
- Great Local Amenities
- Communal Swimming Pool
- Sought-after Development

Energy Efficiency Rating

	Current	Potential
Very energy efficient - lower running costs		
(92+) A		
(81 to 91) B		
(69 to 80) C		
(55 to 68) D	63	71
(39 to 54) E		
(21 to 38) F		
(1 to 20) G		
Not energy efficient - higher running costs		
England & Wales	EU Directive 2002/91/EC	

haart is a trading style of Spicerhaart Limited (Registered No. 3094936). Registered Office: Colwyn House, Sheepen Place, Colchester, Essex CO3 3LD.

haart is the seller's agent for the sale and marketing of the property described on these property particulars and your conveyancer is legally responsible for ensuring that the purchase agreement fully protects your position as a purchaser. haart makes detailed enquiries of the seller to ensure that the information provided is as accurate as possible. However, if you become aware that any of the information provided to you is inaccurate please inform your haart representative as soon as possible so we can make the necessary correction. The services at the property have not been tested.

HRT_011110_005811

